

Locating Fire Rated Joint Systems

1. Click on "Find Joint Systems"

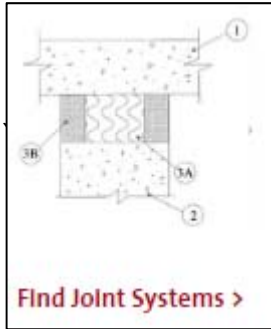

2. When you do not know the assembly number (most common search). Start with the "Joint System" search box.

Example: I need to find a dynamic fire rated joint that occurs between the top of a U401 wall (Head-of-Wall) and a D905 floor-ceiling assembly.

IMPORTANT: [click here to understand joint basics and the numbering system](#)

Place your cursor in the Joint Systems search box, and pick the pre-populated filter "Head-of-Wall"

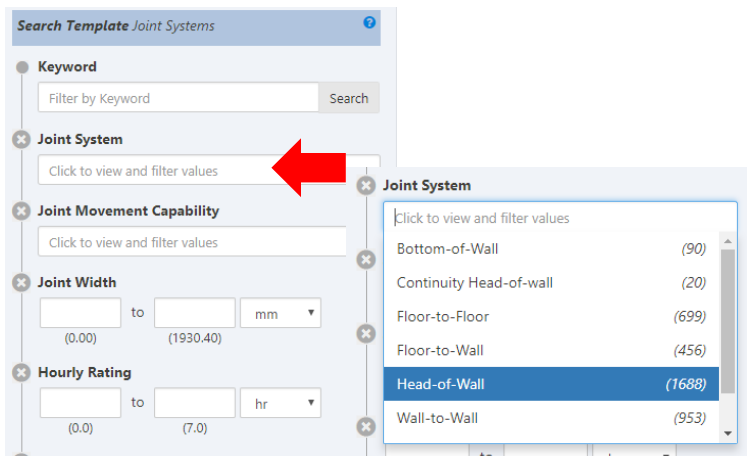

3. Add the Joint Width and Hourly Rating

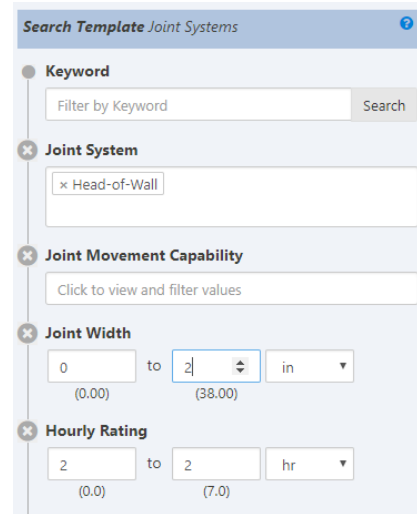

Hint:
Many joints are typically less than 2" wide. Start your search by using "0 to 2"

4. Enter Keyword U400 and D900. You can filter Joint Systems by entering the wall series number or floor-ceiling series number. Entering the exact design number U401 and/or D905 will not work.

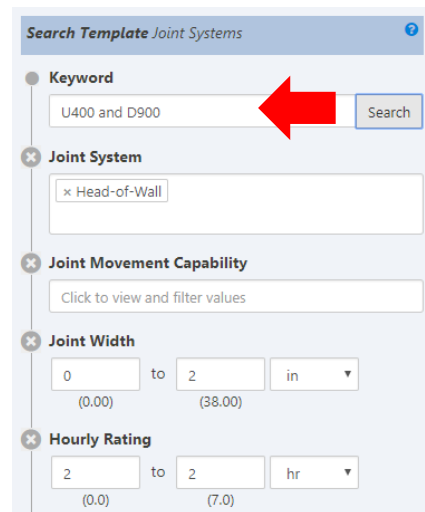

Hint:
Other useful keywords:
"U400 and beam"
head of wall below a beam
"U400 and concrete"
head of wall below a concrete surface

5. US and Canadian design can also be filtered:

